



Fitness and Fun for Everyone

2025 Timnath Recreation Center Proposal

Preliminary Floor Plans for Proposed Recreation Center

Upper Level

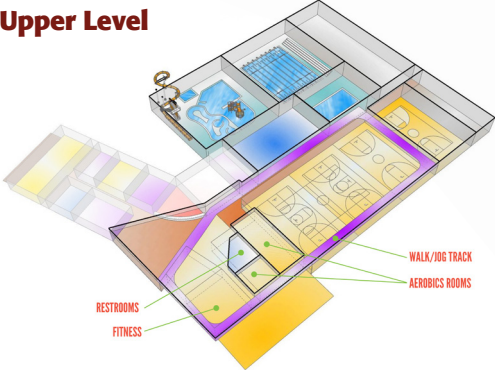

Main Level

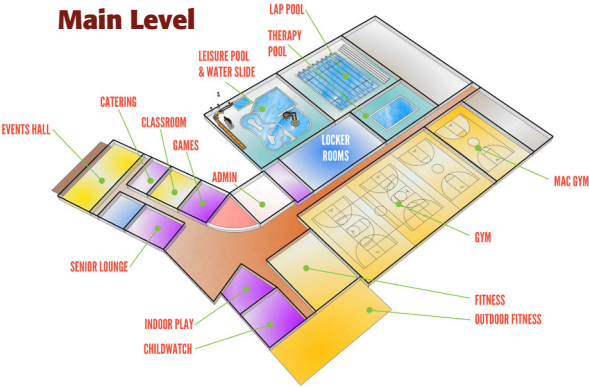

Proposed Location

The proposed recreation center would be centrally located adjacent to the new Timnath Parkway and 4th Avenue. This site is already owned by the Town and would provide convenient access and the opportunity for ample parking.



Many Anticipated Benefits

The new recreation center would have many anticipated benefits, including:

- ✓ Improving residents' overall quality of life
- ✓ Providing year-round, indoor access to certain sports, recreational programs, and fitness
- ✓ Promoting healthy lifestyle choices
- ✓ Keeping seniors, families, teens, and children active and engaged
- ✓ Strengthening community connections
- ✓ Enabling expanded and improved programming for all ages
- ✓ Attracting families, professionals, and businesses to the community
- ✓ Protecting property values

A Sensible Financing Solution

If the Town proceeds with the proposal, a 1.25% sales and use tax measure would be sought. Those funds, along with approximately \$8 million in developer impact fees, would be used to build and operate the \$98 million Timnath Recreation Center.

- ✓ The proposal is NOT a property tax measure, so there's less burden on homeowners
- ✓ A sales and use tax applies to all applicable in-town purchases, including those bought by visitors
- ✓ Timnath's major retailers draw a high volume of out-of-town shoppers
- ✓ A 1.25% sales and use tax adds just 12.5 cents to an applicable \$10 purchase
- ✓ Sales and use tax revenues accumulate faster than property tax revenues
- ✓ Once the construction financing is paid off, the tax would be reduced to 0.25% to help operate and maintain the recreation center

Lowest Area Sales Tax Rates

Timnath's current sales tax rate for food (home consumption) is 2.25% and its tax on building materials and motor vehicle sales is 3.0%. Those rates are among the lowest when compared to neighboring towns.

Rate	Loveland	Severance	Wellington	Johnstown	Longmont	Windsor	Berthoud	Greeley	Fort Collins	Estes Park
Sales Tax	3.00%	3.00%	3.00%	3.50%	3.53%	3.65%	4.00%	4.11%	4.35%	5.00%
Food (Home Consumption)		3.00%	3.00%	3.50%	3.53%	3.65%	4.00%	3.46%	2.25%	5.00%

Timnath Current
2.25% - Food (Home Consumption)
Sales Tax
3.00% - Sales Tax

Timnath Proposed
3.5% - Food (Home Consumption)
Sales Tax

Timnath Proposed
4.25% - Sales Tax



For more information:
Scan or visit
Timnath.org/RecCenter



Proposed Programs and Amenities: Something for Everyone

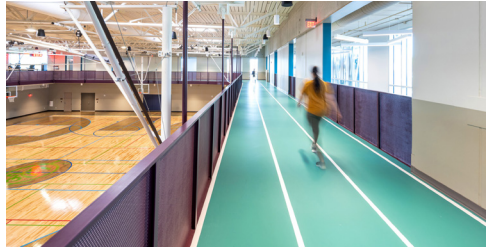

Pictured above are examples of potential recreation center features.

Proposed Amenities

- Walk/Jog Track
- Recreation/Activity Pool
- Competition/Lap Pool
- Warm-Water Therapy Pool
- 15-Person Whirlpool/Spa
- Fitness Room (Cardio/Weights)
- Three-Court Gym
- Multi-Use Gym
- Group Fitness/Dance Studios
- Game Room
- Indoor Playground
- Multipurpose Rooms
- Outdoor Fitness/Training Area
- 240-Capacity Event Hall
- Commercial Kitchen
- Outdoor Patio/Fire Pits
- Senior Lounge



For more information:
Scan or visit
Timnath.org/RecCenter



Fitness and Fun for Everyone

Proposed Programs

Fitness

- Personal Training
- Group Fitness Classes
- Youth Weight Training
- Cycling Classes
- Yoga
- Tai Chi
- Health and Wellness Educational Classes

Aquatics

- Swim Lessons
- Swim Team
- Masters Swim Team
- Water Aerobics
- Private Swim Lessons
- Birthday Parties
- Lifeguard Classes

General Programming

- Dance/Cheer
- Youth Ballet
- First Aid and CPR
- Babysitter Training
- Cooking Classes
- Arts and Crafts
- Esports

Athletics

- Youth Sports Camps
- Adult Basketball Leagues
- Adult Volleyball Leagues
- Adaptive Recreation Programs
- Youth Basketball
- Youth Volleyball
- Pickleball
- Pickleball Leagues