

Notice of Neighborhood Meeting

April 15, 2024

To Whom It May Concern:

A neighborhood meeting will be held **May 2, 2024**, from **5:30 PM to 7:30 PM** for the **Trailside Multi-Family Site Plan Application**. The meeting will be held at **Timnath Town Center at 4750 Signal Tree Drive in the Town Hall Community Room**.

Proposal Name	Trailside Multi-Family Site Plan Application Number: ST-2024-0002
Proposal/Description	Proposal for a multi-family residential development consisting of 168 units and associated amenities. The application proposes updates to a previously approved Site Plan application for the property. (Application # ST-2021-0004). The proposed development will meet the overall vision and intent of the Timnath Land Use Code and the Rendezvous Planned Development Overlay, of which permits multi-family residential on this property.
Site Location	Located at the northwest intersection of Timnath Trail Road and Stone Fly Drive. Current Parcel Number: 86022-39-001
Property Owner	Timnath Living, LLC
Applicant	Norris Design
Primary Contact	Savanah Benedick-Welch, Norris Design, sbwelch@norris-design.com
Property Size	8.49 acres
Current Zoning	R-3 Residential w/ Rendezvous Planned Development Overlay
Development Process	Development Site Plan: following the Neighborhood Meeting, additional staff review will occur, followed by public hearings with the Planning Commission and Town Council.

At the neighborhood meeting, the applicant will provide an overview of the proposal and required process. During the meeting, Town staff and the applicant will be available to respond to your comments and questions regarding the proposal and process. If you are unable to attend the meeting, you may reach out to Savanah Benedick-Welch (contact information above) for a copy of the presentation. The submittal materials can also be found at this link: <https://aca-prod.accela.com/TIMNATH/Cap/CapDetail.aspx?Module=Planning&TabName=Planning&capID1=REC24&capID2=00000&capID3=0000F&agencyCode=TIMNATH>.

Vicinity

Map

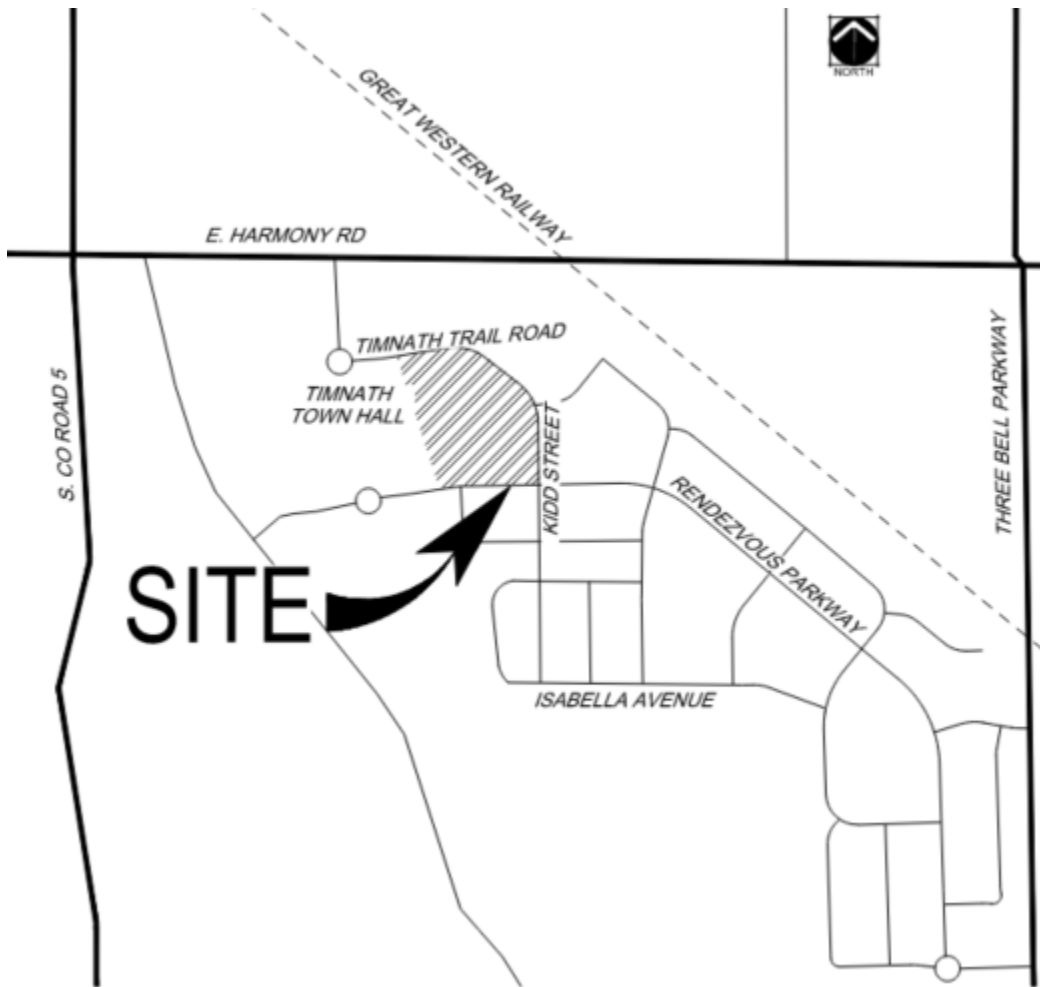

SITE

Map is not to scale

