



# Timnath Reservoir Master Plan

# Timnath Reservoir



# Master Plan Process



## Site Inventory and Analysis

- Design team site visit to explore entire property that was accessible.
- Review of the available survey data from surrounding projects.
- Review of a detailed aerial photo for areas that were not accessible at the site visit.



# Analysis Board



-  Public Streets  
(Public Access)
-  Entry Drive  
(Public Access)
-  Service Roads  
(No Public Vehicle Access)
-  Dam Roads  
(No Public Vehicle Access)
-  Pathways
-  Main Entry  
(Public Access)
-  Limited Access Point  
(No Public Vehicle Access)
-  Improved Public Parking
-  Gates
-  Point of Interest
-  Public Boat Access
-  Prevailing Wind Direction
-  Reservoir Co. Facility  
(No Public Access)
-  Private Residence  
(No Public Access)



## TIMNATH RESERVOIR SITE ANALYSIS

TIMNATH COMMUNITY  
DEVELOPMENT  
OCTOBER 2016

# Master Plan Process

## Programing Effort

- Conduct Public Open House
  - Well Attended approximately 45 visitors over a 3 hour period.
  - Exhibited program elements to gauge interest from the public
- Conducted Online Survey
  - 190 participants completed the survey.
  - Survey content was directly related to the Open House Exhibits
- Program was determined based on the Survey Results and discussion with Town Staff and Town Council

# Survey Results

## Design Direction Response

- 1 (Native) to 5 (Developed)
- Average response is 2.3
- Most popular response 1 (38%)

# Survey Results

## Landscape Direction Response

- 1 (not important) to 5 (more important)
- Native Prairie Plantings (3.93)
- Traditional Park Turf (2.83)

# Survey Results

## Shelter Types Response

- 1 (not important) to 5 (more important)
- Restrooms (3.77)
- Individual Picnic Shelters (2.83)
- Group Picnic Shelters (2.49)
- Outdoor Showers (1.93)



# Survey Results

## Amenities Response

- 1 (not important) to 5 (more important)
- Benches and Boulder Seating (3.04)
- Drinking Fountains (2.89)
- Grills (2.39)
- Bike Tools (1.83)

# Survey Results

## Trail Types Response

- 1 (not important) to 5 (more important)
- **Soft Trails (3.95)**
- **Interpretive Trails (2.88)**
- **Paved Trails (2.55)**

# Survey Results

## Water Based Activities and Uses Response

1 (not important) to 5 (more important)

- Non Motorized Paddle Sports (4.09)
- Shoreline Fishing (3.72)
- Boat Fishing (3.57)
- Birding (3.35)
- Swim Beach (3.35)
- Sailing (2.92)
- Water Skiing (2.38)

# Survey Results

## Shore Based Activities and Uses Response

- 1 (not important) to 5 (more important)
- Horseshoes (2.47)
- Sand Volleyball (2.37)
- Dog Park (2.33)
- Frisbee Golf (2.26)

# Survey Results

## Organized Sports Activities Response

- 1 (not important) to 5 (more important)
- Open Space Fields (3.47)
- Fields with no lights (2.41)
- All other responses under 2
  - Fields with lights
  - Tennis / Pickleball
  - Basketball

# Master Plan Process

## Site Visits

The design team visited three locations in the region to evaluate program elements and site design.

- Horsetooth Reservoir
  - Sunrise Day Use Area
  - South Bay Day Use Area
- Carter Lake Day Use Area
- Boyd Lake State Park



# Timnath Reservoir Master Plan

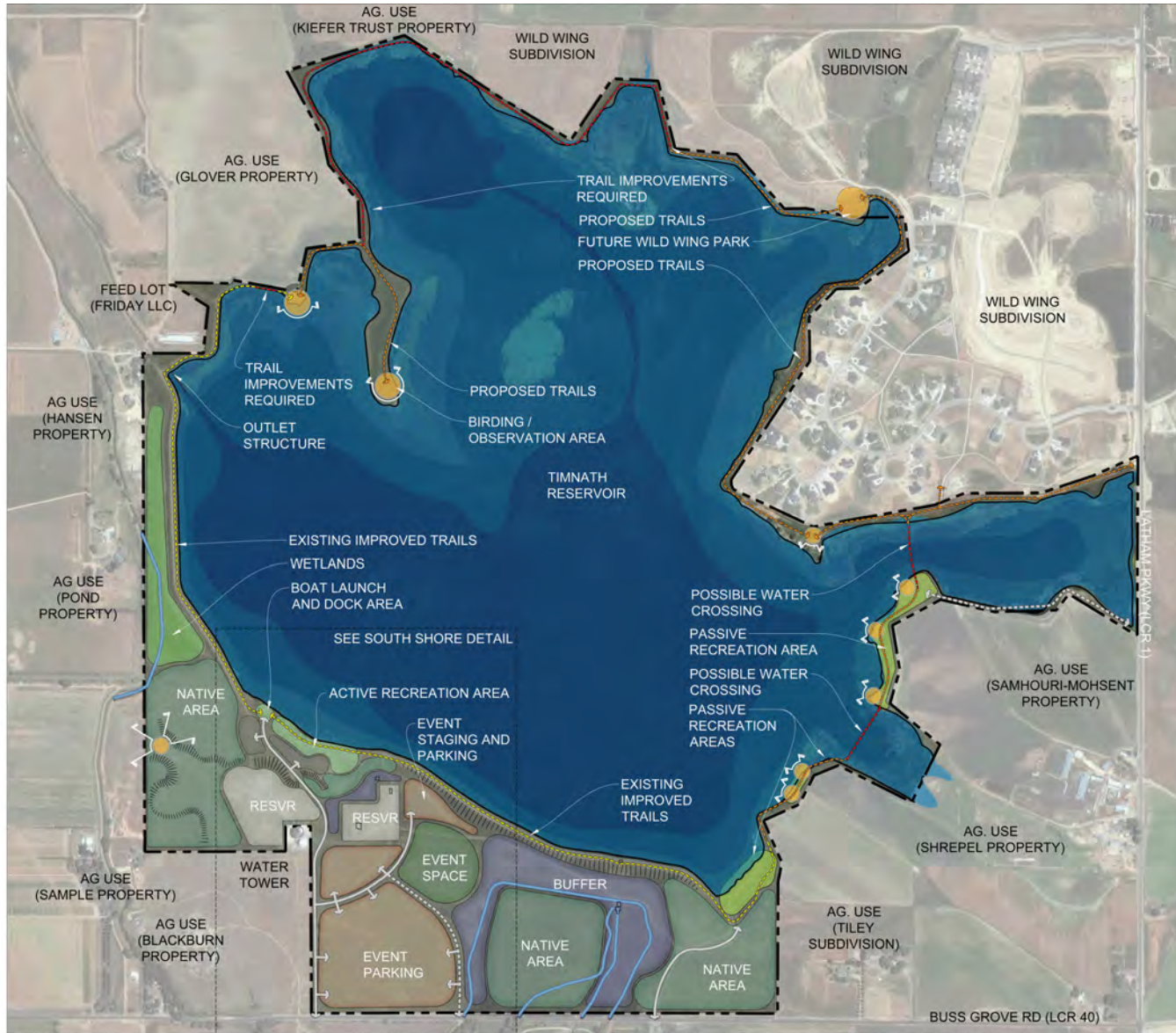

## SYMBOL LEGEND

- FULL ACCESS ROADS
- LIMITED ACCESS ROADS
- EXISTING IMPROVED TRAILS
- PROPOSED TRAILS
- PROPOSED TRAILS EXPOSED TO FLOODING
- IRRIGATION DITCH
- POINT OF INTEREST / DESTINATION
- STEEP SLOPE

## ACTIVE RECREATION AREA AMENITIES

- PAVILION
- PICNIC AREA WITH SHELTERS
- BEACH SAND AREA
- PAVED TRAILS
- TURF AREA
- RESTROOMS
- DRINKING FOUNTAINS
- RINSING / SHOWERS

## PASSIVE AREA AMENITIES

- PICNIC AREA WITH SHELTERS
- BIRDING PAVED TRAILS
- BEACH AREA
- SHORE FISHING
- NON-MOTORIZED BOAT LAUNCH

## CONSTRUCTION PHASING

- 2017-18 - EVENT AREA IMPROVEMENTS
- FUTURE PHASING
- SOUTH SHORE / ACTIVE AREA DEVELOPMENT
- TRAIL IMPROVEMENTS AND CONNECTIVITY



SCALE 1" = 250'



# Timnath Reservoir Master Plan South Shore Detail

# Next Steps

## Second Survey

Public Input on Access Policy for Non Residents

Prioritization of Amenities and Trail Improvements

Adoption of Master Plan by Planning Commission and Town Council

Phase 1 Design and Improvements